

# Circular sensor connectors



## **M16** cables & connectors

The M16 Series is an ideal choice for intensive industrial and commercial applications. Over-molded cable, assembly type and panel-mount receptacles are available in various styles and mounting methods. Quick-locking wiring assembly type is also available.

- Degree of protection IP65/IP67
- 2~9, 14, 19 poles are available
- TPU over molded or TPU plastic body
- Cable length customized, PUR and PVC cable options
- Anti-vibration locking screw design

M16 Quick Search Table	Locking type	Fix screw																				Quick-lock											
	Rated Current	7A(40°C)				6A(40°C)				6A(40°C)				5A(40°C)				5A(40°C)				3A(40°C)				4A							
	Voltage	250V(A/C), 32V(D/C)				250V(A/C), 32V(D/C)				60V(A/C), 32V(D/C)				250V(A/C), 32V(D/C)				125V(A/C), 32V(D/C)				60V(A/C), 32V(D/C)				60V(A/C), 32V(D/C)				250V(A/C), 300V(D/C)			
	Wire Gauge / size	18AWG / 0.75mm <sup>2</sup>				18AWG / 0.75mm <sup>2</sup>				18AWG / 0.75mm <sup>2</sup>				18AWG / 0.75mm <sup>2</sup>				18AWG / 0.75mm <sup>2</sup>				18AWG / 0.75mm <sup>2</sup>				Max.24AWG / Max.0.25mm <sup>2</sup>				22AWG / 0.34mm <sup>2</sup>			
Pin layout																																	
M16 cables & connectors		02 Pins		03 Pins		04 Pins		05 Pins-a		05 Pins-b		06 Pins		07 Pins-a		07 Pins-b		08 Pins		14 Pins		19 Pins		08 Pins		09 Pins							
<b>Molded Cable</b>																																	
	Male Molded Cable Straight	293	-	293	-	293	-	293	-	293	-	293	-	293	-	293	-	293	-	293	-	293	-	-	-	-	-						
	Female Molded Cable Straight	-	294	-	294	-	294	-	294	-	294	-	294	-	294	-	294	-	294	-	294	-	294	-	-	-	-	-					
	Male Molded Cable Angled	295	-	295	-	295	-	295	-	295	-	295	-	295	-	295	-	295	-	295	-	295	-	-	-	-	-	-					
	Female Molded Cable Angled	-	296	-	296	-	296	-	296	-	296	-	296	-	296	-	296	-	296	-	296	-	296	-	-	-	-	-					
<b>Assembly Type</b>																																	
	Male Field Wirable Assembly Straight Solder	297	-	297	-	297	-	297	-	297	-	297	-	297	-	297	-	297	-	297	-	297	-	-	-	-	-						
	Female Field Wirable Assembly Straight Solder	-	298	-	298	-	298	-	298	-	298	-	298	-	298	-	298	-	298	-	298	-	298	-	-	-	-	-					
<b>Panel Mount Type</b>																																	
	Male Panel Mount Die-cast Screw Solder Front fastened	299	-	299	-	299	-	299	-	299	-	299	-	299	-	299	-	299	-	299	-	299	-	-	-	-	-						
	Male Panel Mount Die-cast Screw Solder Rear fastened	301	-	301	-	301	-	301	-	301	-	301	-	301	-	301	-	301	-	301	-	301	-	-	-	-	-						
	Female Panel Mount Die-cast Screw Solder Front fastened	-	300	-	300	-	300	-	300	-	300	-	300	-	300	-	300	-	300	-	300	-	300	-	-	-	-	-					
	Female Panel Mount Die-cast Screw Solder Rear fastened	-	302	-	302	-	302	-	302	-	302	-	302	-	302	-	302	-	302	-	302	-	302	-	-	-	-	-					
<b>Molded Cable</b>																																	
	Male Molded Cable Straight Quick-lock Type	-	-	-	-	-	-	-	-	-	-	-	-	-	-	-	-	-	-	-	-	-	-	-	303	-	303	-					
	Female Molded Cable Straight Quick-lock Type	-	-	-	-	-	-	-	-	-	-	-	-	-	-	-	-	-	-	-	-	-	-	-	-	304	-	304	-				
	Female Molded Cable Straight Quick-lock Type with Fix-Cap	-	-	-	-	-	-	-	-	-	-	-	-	-	-	-	-	-	-	-	-	-	-	-	-	305	-	305	-				
<b>Assembly Type</b>																																	
	Male Field Wirable Assembly Straight Quick-lock Type Solder	-	-	-	-	-	-	-	-	-	-	-	-	-	-	-	-	-	-	-	-	-	-	-	306	-	306	-					
	Female Field Wirable Assembly Straight Quick-lock Type Solder	-	-	-	-	-	-	-	-	-	-	-	-	-	-	-	-	-	-	-	-	-	-	-	-	307	-	307	-				
	Female Field Wirable Assembly Straight Solder with Fix-cap	-	-	-	-	-	-	-	-	-	-	-	-	-	-	-	-	-	-	-	-	-	-	-	-	308	-	308	-				
<b>Panel Mount Type</b>																																	
	Male Panel Mount Quick-lock Type Solder Front fastened	-	-	-	-	-	-	-	-	-	-	-	-	-	-	-	-	-	-	-	-	-	-	-	309	-	309	-					
	Female Panel Mount Quick-lock Type Solder Front fastened	-	-	-	-	-	-	-	-	-	-	-	-	-	-	-	-	-	-	-	-	-	-	-	-	310	-	310	-				
	Male Panel Mount Quick-lock Typ PCB Front fastened	-	-	-	-	-	-	-	-	-	-	-	-	-	-	-	-	-	-	-	-	-	-	-	-	311	-	311	-				
	Female Panel Mount Quick-lock Typ PCB Front fastened	-	-	-	-	-	-	-	-	-	-	-	-	-	-	-	-	-	-	-	-	-	-	-	-	312	-	312	-				
<b>Protection Cap</b>																																	
	Protection Cap for Male With Fix-Cap Cable Connector	313-1																															
	Protection Cap for Female Molded Cable Connector																																
	Protection Cap for Male/Female Panel mount Connector	314-1																															

M16 cables & connectors

M16 cables & connectors

## How to Order Part Number

### ■ M16 Series with cable molded

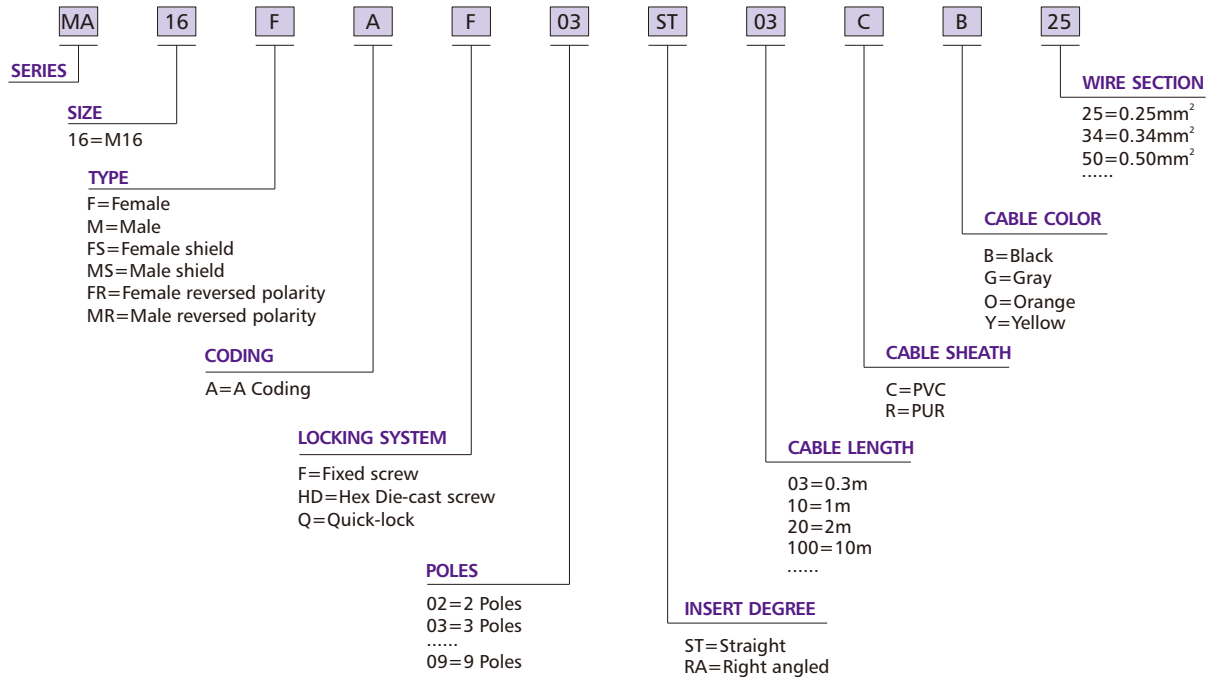

### ■ M16 Series Assembly / Panel-mount type

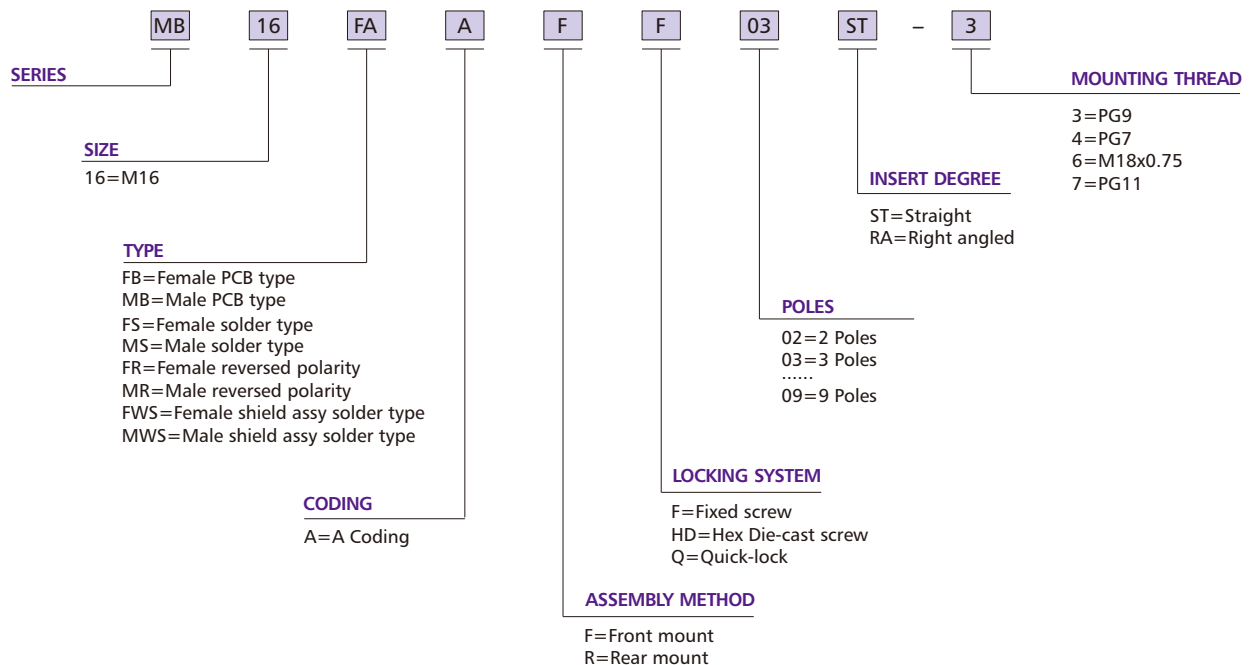

## M16 Male Molded Cable, Straight

- Connector series: M16
- Gender: Male
- Locking type: Fix screw
- Mounting type: Straight
- Part No.: MA16MAF\*\*STXXXXXX

\*\* refers to pins number  
X refers to cable specification

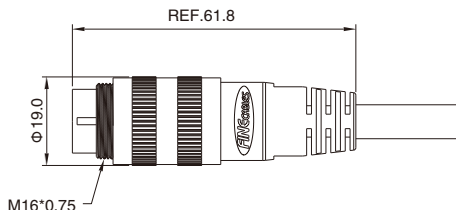

### General information

Standard:	IEC 61076-2-106
Ambient temperature:	-40°C ~ +70°C(fixed installation) -25°C ~ +70°C(flexible installation)
Connector insert:	BPT
Connector contacts:	Brass with gold plated
Connector overmold:	TPU

Coupling screw:	Zinc alloy with nickel plated
Insulation resistance:	≥ 100MΩ
Contact resistance :	≤ 5mΩ
Shielding:	Available/Unavailable
IP rating:	IP65, IP67 in locked condition
Mating endurance:	>100 cycles

### Electrical data & Mechanical data

Contacts	Rated current	Voltage		Wire gauge / size		Cable jacket	Part No.
		A/C	D/C	AWG	mm <sup>2</sup>		
02 pins	7A(40°C)	250V	32V	18AWG	0.75	PUR/PVC	MA16MAF02STXXXXB75 MA16M <sub>SAF</sub> 02STXXXXB75
03 pins	7A(40°C)	250V	32V	18AWG	0.75	PUR/PVC	MA16MAF03STXXXXB75 MA16M <sub>SAF</sub> 03STXXXXB75
04 pins	6A(40°C)	250V	32V	18AWG	0.75	PUR/PVC	MA16MAF04STXXXXB75 MA16M <sub>SAF</sub> 04STXXXXB75
05 pins-a	6A(40°C)	250V	32V	18AWG	0.75	PUR/PVC	MA16MAF05ASTXXXXB75 MA16M <sub>SAF</sub> 05ASTXXXXB75
05 pins-b	6A(40°C)	60V	32V	18AWG	0.75	PUR/PVC	MA16MAF05BSTXXXXB75 MA16M <sub>SAF</sub> 05BSTXXXXB75
06 pins	5A(40°C)	250V	32V	18AWG	0.75	PUR/PVC	MA16MAF06STXXXXB75 MA16M <sub>SAF</sub> 06STXXXXB75
07 pins-a	5A(40°C)	125V	32V	18AWG	0.75	PUR/PVC	MA16MAF07ASTXXXXB75 MA16M <sub>SAF</sub> 07ASTXXXXB75
07 pins-b	5A(40°C)	60V	32V	18AWG	0.75	PUR/PVC	MA16MAF07BSTXXXXB75 MA16M <sub>SAF</sub> 07BSTXXXXB75
08 pins	5A(40°C)	60V	32V	18AWG	0.75	PUR/PVC	MA16MAF08STXXXXB75 MA16M <sub>SAF</sub> 08STXXXXB75
14 pins	3A(40°C)	60V	32V	Max.24AWG	Max.0.25	PUR/PVC	MA16MAF14STXXXXXX MA16M <sub>SAF</sub> 14STXXXXXX
19 pins	3A(40°C)	60V	32V	Max.24AWG	Max.0.25	PUR/PVC	MA16MAF19STXXXXXX MA16M <sub>SAF</sub> 19STXXXXXX

### Remarks

Note: X refers to cable specification, S : Shielded

- Please refer to Page 578 for the Conversion between American Wire Gauge AWG and Wire Cross-section mm<sup>2</sup>.
- Please Refer to page 292 for products' part number encoding rule.

## M16 Female Molded Cable, Straight

- Connector series: M16
- Gender: Female
- Locking type: Fix screw
- Mounting type: Straight
- Part No.: MA16FAF\*\*STXXXXXX

\*\* refers to pins number  
X refers to cable specification

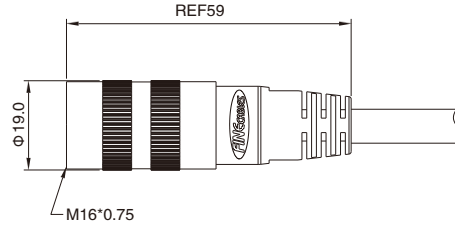

### General information

Standard:	IEC 61076-2-106
Ambient temperature:	-40°C ~ +70°C(fixed installation) -25°C ~ +70°C(flexible installation)
Connector insert:	BPT
Connector contacts:	Brass with gold plated
Connector overmold:	TPU

Seal/ O-ring:	Zinc alloy with nickel plated
Coupling screw:	NBR/FKM
Insulation resistance:	≥ 100MΩ
Contact resistance :	≤ 5mΩ
Shielding:	Available/Unavailable
IP rating:	IP65, IP67 in locked condition
Mating endurance:	>100 cycles

### Electrical data & Mechanical data

Contacts	Rated current	Voltage		Wire gauge / size		Cable jacket	Part No.
		A/C	D/C	AWG	mm <sup>2</sup>		
02 pins	7A(40°C)	250V	32V	18AWG	0.75	PUR/PVC	MA16FAF02STXXXXB75 MA16FSAF02STXXXXB75
03 pins	7A(40°C)	250V	32V	18AWG	0.75	PUR/PVC	MA16FAF03STXXXXB75 MA16FSAF03STXXXXB75
04 pins	6A(40°C)	250V	32V	18AWG	0.75	PUR/PVC	MA16FAF04STXXXXB75 MA16FSAF04STXXXXB75
05 pins-a	6A(40°C)	250V	32V	18AWG	0.75	PUR/PVC	MA16FAF05ASTXXXXB75 MA16FSAF05ASTXXXXB75
05 pins-b	6A(40°C)	60V	32V	18AWG	0.75	PUR/PVC	MA16FAF05BSTXXXXB75 MA16FSAF05BSTXXXXB75
06 pins	5A(40°C)	250V	32V	18AWG	0.75	PUR/PVC	MA16FAF06STXXXXB75 MA16FSAF06STXXXXB75
07 pins-a	5A(40°C)	125V	32V	18AWG	0.75	PUR/PVC	MA16FAF07ASTXXXXB75 MA16FSAF07ASTXXXXB75
07 pins-b	5A(40°C)	60V	32V	18AWG	0.75	PUR/PVC	MA16FAF07BSTXXXXB75 MA16FSAF07BSTXXXXB75
08 pins	5A(40°C)	60V	32V	18AWG	0.75	PUR/PVC	MA16FAF08STXXXXB75 MA16FSAF08STXXXXB75
14 pins	3A(40°C)	60V	32V	Max.24AWG	Max.0.25	PUR/PVC	MA16FAF14STXXXXXX MA16FSAF14STXXXXXX
19 pins	3A(40°C)	60V	32V	Max.24AWG	Max.0.25	PUR/PVC	MA16FAF19STXXXXXX MA16FSAF19STXXXXXX

### Remarks

Note: X refers to cable specification, S : Shielded

- Please refer to Page 578 for the Conversion between American Wire Gauge AWG and Wire Cross-section mm<sup>2</sup>.
- Please Refer to page 292 for products' part number encoding rule.

## M16 Male Molded Cable, Angled

- Connector series: M16
- Gender: Male
- Locking type: Fix screw
- Mounting type: Right angled
- Part No.: MA16MAF\*\*RAXXXXXX

\*\* refers to pins number  
X refers to cable specification

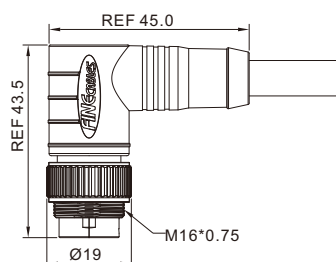

RoHS

### General information

Standard:	IEC 61076-2-106
Ambient temperature:	-40°C ~ +70°C(fixed installation) -25°C ~ +70°C(flexible installation)
Connector insert:	BPT
Connector contacts:	Brass with gold plated
Connector overmold:	TPU

Coupling screw:	Zinc alloy with nickel plated
Insulation resistance:	≥ 100MΩ
Contact resistance :	≤ 5mΩ
Shielding:	Available/Unavailable
IP rating:	IP65, IP67 in locked condition
Mating endurance:	>100 cycles

### Electrical data & Mechanical data

Contacts	Rated current	Voltage		Wire gauge / size		Cable jacket	Part No.
		A/C	D/C	AWG	mm <sup>2</sup>		
02 pins	7A(40°C)	250V	32V	18AWG	0.75	PUR/PVC	MA16MAF02RAXXXB75 MA16MSAF02RAXXXB75
03 pins	7A(40°C)	250V	32V	18AWG	0.75	PUR/PVC	MA16MAF03RAXXXB75 MA16MSAF03RAXXXB75
04 pins	6A(40°C)	250V	32V	18AWG	0.75	PUR/PVC	MA16MAF04RAXXXB75 MA16MSAF04RAXXXB75
05 pins-a	6A(40°C)	250V	32V	18AWG	0.75	PUR/PVC	MA16MAF05ARAXXXB75 MA16MSAF05ARAXXXB75
05 pins-b	6A(40°C)	60V	32V	18AWG	0.75	PUR/PVC	MA16MAF05BRAXXXB75 MA16MSAF05BRAXXXB75
06 pins	5A(40°C)	250V	32V	18AWG	0.75	PUR/PVC	MA16MAF06RAXXXB75 MA16MSAF06RAXXXB75
07 pins-a	5A(40°C)	125V	32V	18AWG	0.75	PUR/PVC	MA16MAF07ARAXXXB75 MA16MSAF07ARAXXXB75
07 pins-b	5A(40°C)	60V	32V	18AWG	0.75	PUR/PVC	MA16MAF07BRAXXXB75 MA16MSAF07BRAXXXB75
08 pins	5A(40°C)	60V	32V	18AWG	0.75	PUR/PVC	MA16MAF08RAXXXB75 MA16MSAF08RAXXXB75
14 pins	3A(40°C)	60V	32V	Max.24AWG	Max.0.25	PUR/PVC	MA16MAF14RAXXXXXX MA16MSAF14RAXXXXXX
19 pins	3A(40°C)	60V	32V	Max.24AWG	Max.0.25	PUR/PVC	MA16MAF19RAXXXXXX MA16MSAF19RAXXXXXX

### Remarks

Note: X refers to cable specification, S : Shielded

- Please refer to Page 578 for the Conversion between American Wire Gauge AWG and Wire Cross-section mm<sup>2</sup>.
- Please Refer to page 292 for products' part number encoding rule.

## M16 Female Molded Cable, Angled

- Connector series: M16
- Gender: Female
- Locking type: Fix screw
- Mounting type: Right angled
- Part No.: MA16FAF\*\*RAXXXXXX

\*\* refers to pins number  
X refers to cable specification

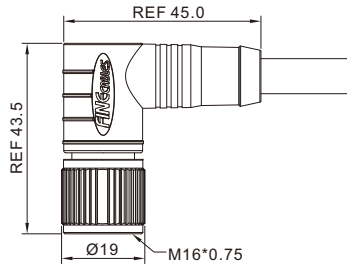

### General information

Standard:	IEC 61076-2-106
Ambient temperature:	-40°C ~ +70°C (fixed installation) -25°C ~ +70°C (flexible installation)
Connector insert:	BPT
Connector contacts:	Brass with gold plated
Connector overmold:	TPU

Seal/ O-ring:	Zinc alloy with nickel plated
Coupling screw:	NBR/FKM
Insulation resistance:	≥ 100MΩ
Contact resistance :	≤ 5mΩ
Shielding:	Available/Unavailable
IP rating:	IP65, IP67 in locked condition
Mating endurance:	>100 cycles

### Electrical data & Mechanical data

Contacts	Rated current	Voltage		Wire gauge / size		Cable jacket	Part No.
		A/C	D/C	AWG	mm <sup>2</sup>		
02 pins	7A(40°C)	250V	32V	18AWG	0.75	PUR/PVC	MA16FAF02RAXXXB75 MA16FSAF02RAXXXB75
03 pins	7A(40°C)	250V	32V	18AWG	0.75	PUR/PVC	MA16FAF03RAXXXB75 MA16FSAF03RAXXXB75
04 pins	6A(40°C)	250V	32V	18AWG	0.75	PUR/PVC	MA16FAF04RAXXXB75 MA16FSAF04RAXXXB75
05 pins-a	6A(40°C)	250V	32V	18AWG	0.75	PUR/PVC	MA16FAF05ARAXXXB75 MA16FSAF05ARAXXXB75
05 pins-b	6A(40°C)	60V	32V	18AWG	0.75	PUR/PVC	MA16FAF05BRAXXXB75 MA16FSAF05BRAXXXB75
06 pins	5A(40°C)	250V	32V	18AWG	0.75	PUR/PVC	MA16FAF06RAXXXB75 MA16FSAF06RAXXXB75
07 pins-a	5A(40°C)	125V	32V	18AWG	0.75	PUR/PVC	MA16FAF07ARAXXXB75 MA16FSAF07ARAXXXB75
07 pins-b	5A(40°C)	60V	32V	18AWG	0.75	PUR/PVC	MA16FAF07BRAXXXB75 MA16FSAF07BRAXXXB75
08 pins	5A(40°C)	60V	32V	18AWG	0.75	PUR/PVC	MA16FAF08RAXXXB75 MA16FSAF08RAXXXB75
14 pins	3A(40°C)	60V	32V	Max.24AWG	Max.0.25	PUR/PVC	MA16FAF14RAXXXXXX MA16FSAF14RAXXXXXX
19 pins	3A(40°C)	60V	32V	Max.24AWG	Max.0.25	PUR/PVC	MA16FAF19RAXXXXXX MA16FSAF19RAXXXXXX

### Remarks

Note: X refers to cable specification, S : Shielded

- Please refer to Page 578 for the Conversion between American Wire Gauge AWG and Wire Cross-section mm<sup>2</sup>.
- Please Refer to page 292 for products' part number encoding rule.

## M16 Male Field Wirable Assembly, Straight, Solder

- Connector series: M16
- Gender: Male
- Locking type: Fix screw
- Mounting type: Straight
- Part No.: MB16MWSAFF\*\*ST-X

\*\* refers to pins number  
 X Suitable cable Dia: 3=PG9, 4=PG7, 7=PG11

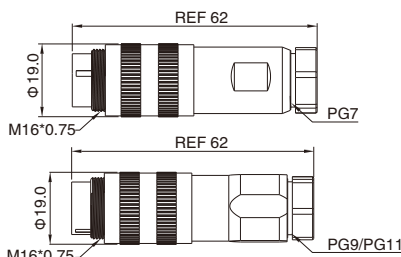

### General information

Standard:	IEC 61076-2-106
Ambient temperature:	-25°C ~ +70°C
Connector insert:	BPT
Connector contacts:	Brass with gold plated
Connector screw/body:	Zinc alloy with nickel plated
Coupling screw:	PA+GF

Seal/ O-ring:	NBR/FKM
Insulation resistance:	≥ 100MΩ
Contact resistance :	≤ 5mΩ
Shielding:	Available
Suitable cable Dia:	PG7:4~6; PG9:6~8; PG11:8~10mm
IP rating:	IP65, IP67 in locked condition
Mating endurance:	>100 cycles

### Electrical data & Mechanical data

Contacts	Contact termination	Rated current	Voltage		Wire gauge / size		Cable jacket	Part No.	
			A/C	D/C	AWG	mm <sup>2</sup>			
02 pins		Solder version	7A(40°C)	250V	32V	18AWG	0.75	PUR/PVC	MB16MWSAFF02ST-X
03 pins		Solder version	7A(40°C)	250V	32V	18AWG	0.75	PUR/PVC	MB16MWSAFF03ST-X
04 pins		Solder version	6A(40°C)	250V	32V	18AWG	0.75	PUR/PVC	MB16MWSAFF04ST-X
05 pins-a		Solder version	6A(40°C)	250V	32V	18AWG	0.75	PUR/PVC	MB16MWSAFF05ST-X
05 pins-b		Solder version	6A(40°C)	60V	32V	18AWG	0.75	PUR/PVC	MB16MWSAFF05ST-X
06 pins		Solder version	5A(40°C)	250V	32V	18AWG	0.75	PUR/PVC	MB16MWSAFF06ST-X
07 pins-a		Solder version	5A(40°C)	125V	32V	18AWG	0.75	PUR/PVC	MB16MWSAFF07AST-X
07 pins-b		Solder version	5A(40°C)	60V	32V	18AWG	0.75	PUR/PVC	MB16MWSAFF07BST-X
08 pins		Solder version	5A(40°C)	60V	32V	18AWG	0.75	PUR/PVC	MB16MWSAFF08ST-X
14 pins		Solder version	3A(40°C)	60V	32V	Max.24AWG	Max.0.25	PUR/PVC	MB16MWSAFF14ST-X
19 pins		Solder version	3A(40°C)	60V	32V	Max.24AWG	Max.0.25	PUR/PVC	MB16MWSAFF19ST-X

### Remarks

Note: X Suitable cable Dia: 3=PG9, 4=PG7, 7=PG11

- Please refer to Page 578 for the Conversion between American Wire Gauge AWG and Wire Cross-section mm<sup>2</sup>.
- Please Refer to page 292 for products' part number encoding rule.



## M16 Female Field Wirable Assembly, Straight, Solder

- Connector series: M16
- Gender: Female
- Locking type: Fix screw
- Mounting type: Straight
- Part No.: MB16FWSAFF\*\*ST-X

\*\* refers to pins number  
 X Suitable cable Dia: 3=PG9, 4=PG7,  
 7=PG11

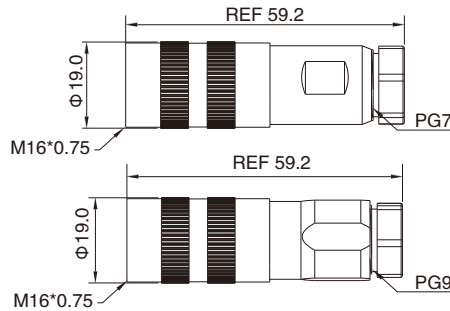

### General information

Standard:	IEC 61076-2-106
Ambient temperature:	-25°C ~ +70°C
Connector insert:	BPT
Connector contacts:	Brass with gold plated
Connector screw/body:	Zinc alloy with nickel plated
Coupling screw:	PA+GF

Seal/ O-ring:	NBR/FKM
Insulation resistance:	≥ 100MΩ
Contact resistance :	≤ 5mΩ
Shielding:	Available
Suitable cable Dia:	PG7:4~6; PG9:6~8; PG11:8~10mm
IP rating:	IP65, IP67 in locked condition
Mating endurance:	>100 cycles

### Electrical data & Mechanical data

Contacts	Contact termination	Rated current	Voltage		Wire gauge / size		Cable jacket	Part No.	
			A/C	D/C	AWG	mm <sup>2</sup>			
02 pins		Solder version	7A(40°C)	250V	32V	18AWG	0.75	PUR/PVC	MB16FWSAFF02ST-X
03 pins		Solder version	7A(40°C)	250V	32V	18AWG	0.75	PUR/PVC	MB16FWSAFF03ST-X
04 pins		Solder version	6A(40°C)	250V	32V	18AWG	0.75	PUR/PVC	MB16FWSAFF04ST-X
05 pins-a		Solder version	6A(40°C)	250V	32V	18AWG	0.75	PUR/PVC	MB16FWSAFF05AST-X
05 pins-b		Solder version	6A(40°C)	60V	32V	18AWG	0.75	PUR/PVC	MB16FWSAFF05BST-X
06 pins		Solder version	5A(40°C)	250V	32V	18AWG	0.75	PUR/PVC	MB16FWSAFF06ST-X
07 pins-a		Solder version	5A(40°C)	125V	32V	18AWG	0.75	PUR/PVC	MB16FWSAFF07AST-X
07 pins-b		Solder version	5A(40°C)	60V	32V	18AWG	0.75	PUR/PVC	MB16FWSAFF07BST-X
08 pins		Solder version	5A(40°C)	60V	32V	18AWG	0.75	PUR/PVC	MB16FWSAFF08ST-X
14 pins		Solder version	3A(40°C)	60V	32V	Max.24AWG	Max.0.25	PUR/PVC	MB16FWSAFF14ST-X
19 pins		Solder version	3A(40°C)	60V	32V	Max.24AWG	Max.0.25	PUR/PVC	MB16FWSAFF19ST-X

### Remarks

Note: X Suitable cable Dia: 3=PG9, 4=PG7, 7=PG11

- Please refer to Page 578 for the Conversion between American Wire Gauge AWG and Wire Cross-section mm<sup>2</sup>.
- Please Refer to page 292 for products' part number encoding rule.

## M16 Male Panel Mount, Die-cast Screw, Solder, Front fastened

- Connector series: M16
- Gender: Male
- Locking type: Fix screw
- Mounting type: Front fastened
- Part No.: MB16MSAFHD\*\*ST-6

\*\* refers to pins number

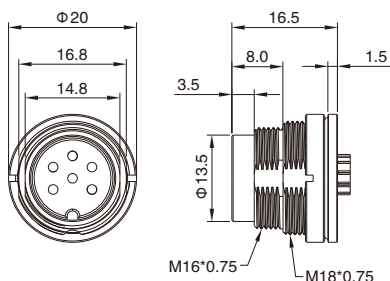

### General information

Standard:	IEC 61076-2-106	Seal/ O-ring:	NBR/FKM
Ambient temperature:	-25°C ~ +70°C	Insulation resistance:	≥ 100MΩ
Connector insert:	BPT	Contact resistance :	≤ 5mΩ
Connector contacts:	Brass with gold plated	Shielding:	Unavailable
Connector screw/body:	Zinc alloy with nickel plated	IP rating:	IP65, IP67 in locked condition
Coupling screw:	Brass with nickel plated	Mating endurance:	>100 cycles

### Electrical data & Mechanical data

Contacts	Contact termination	Rated current	Voltage		Wire gauge / size		Cable jacket	Part No.	
			A/C	D/C	AWG	mm <sup>2</sup>			
02 pins		Solder version	7A(40°C)	250V	32V	18AWG	0.75	PUR/PVC	MB16MSAFHD02ST-6
03 pins		Solder version	7A(40°C)	250V	32V	18AWG	0.75	PUR/PVC	MB16MSAFHD03ST-6
04 pins		Solder version	6A(40°C)	250V	32V	18AWG	0.75	PUR/PVC	MB16MSAFHD04ST-6
05 pins-a		Solder version	6A(40°C)	250V	32V	18AWG	0.75	PUR/PVC	MB16MSAFHD05AST-6
05 pins-b		Solder version	6A(40°C)	60V	32V	18AWG	0.75	PUR/PVC	MB16MSAFHD05BST-6
06 pins		Solder version	5A(40°C)	250V	32V	18AWG	0.75	PUR/PVC	MB16MSAFHD06ST-6
07 pins-a		Solder version	5A(40°C)	125V	32V	18AWG	0.75	PUR/PVC	MB16MSAFHD07AST-6
07 pins-b		Solder version	5A(40°C)	60V	32V	18AWG	0.75	PUR/PVC	MB16MSAFHD07BST-6
08 pins		Solder version	5A(40°C)	60V	32V	18AWG	0.75	PUR/PVC	MB16MSAFHD08ST-6
14 pins		Solder version	3A(40°C)	60V	32V	Max.24AWG	Max.0.25	PUR/PVC	MB16MSAFHD14ST-6
19 pins		Solder version	3A(40°C)	60V	32V	Max.24AWG	Max.0.25	PUR/PVC	MB16MSAFHD19ST-6

### Remarks

- Please refer to Page 578 for the Conversion between American Wire Gauge AWG and Wire Cross-section mm<sup>2</sup>.
- Please Refer to page 292 for products' part number encoding rule.

## M16 Female Panel Mount, Die-cast Screw, Solder, Front fastened

- Connector series: M16
- Gender: Female
- Locking type: Fix screw
- Mounting type: Front fastened
- Part No.: MB16FSAFHD\*\*ST-6

\*\* refers to pins number

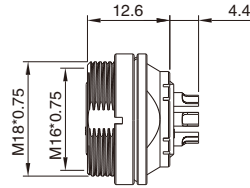
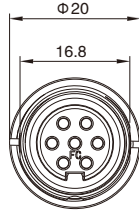

### General information



Standard:	IEC 61076-2-106
Ambient temperature:	-25°C ~ +70°C
Connector insert:	BPT
Connector contacts:	Brass with gold plated
Connector screw/body:	Zinc alloy with nickel plated
Coupling screw:	Brass with nickel plated

Seal/ O-ring:	NBR/FKM
Insulation resistance:	≥ 100MΩ
Contact resistance :	≤ 5mΩ
Shielding:	Unavailable
IP rating:	IP65, IP67 in locked condition
Mating endurance:	>100 cycles

### Electrical data & Mechanical data

Contacts	Contact termination	Rated current	Voltage		Wire gauge / size		Cable jacket	Part No.	
			A/C	D/C	AWG	mm <sup>2</sup>			
02 pins		Solder version	7A(40°C)	250V	32V	18AWG	0.75	PUR/PVC	MB16FSAFHD02ST-6
03 pins		Solder version	7A(40°C)	250V	32V	18AWG	0.75	PUR/PVC	MB16FSAFHD03ST-6
04 pins		Solder version	6A(40°C)	250V	32V	18AWG	0.75	PUR/PVC	MB16FSAFHD04ST-6
05 pins-a		Solder version	6A(40°C)	250V	32V	18AWG	0.75	PUR/PVC	MB16FSAFHD05AST-6
05 pins-b		Solder version	6A(40°C)	60V	32V	18AWG	0.75	PUR/PVC	MB16FSAFHD05BST-6
06 pins		Solder version	5A(40°C)	250V	32V	18AWG	0.75	PUR/PVC	MB16FSAFHD06ST-6
07 pins-a		Solder version	5A(40°C)	125V	32V	18AWG	0.75	PUR/PVC	MB16FSAFHD07AST-6
07 pins-b		Solder version	5A(40°C)	60V	32V	18AWG	0.75	PUR/PVC	MB16FSAFHD07BST-6
08 pins		Solder version	5A(40°C)	60V	32V	18AWG	0.75	PUR/PVC	MB16FSAFHD08ST-6
14 pins		Solder version	3A(40°C)	60V	32V	Max.24AWG	Max.0.25	PUR/PVC	MB16FSAFHD14ST-6
19 pins		Solder version	3A(40°C)	60V	32V	Max.24AWG	Max.0.25	PUR/PVC	MB16FSAFHD19ST-6

### Remarks

- Please refer to Page 578 for the Conversion between American Wire Gauge AWG and Wire Cross-section mm<sup>2</sup>.
- Please Refer to page 292 for products' part number encoding rule.

## M16 Male Panel Mount, Die-cast Screw, Solder, Rear fastened

- Connector series: M16
- Gender: Male
- Locking type: Fix screw
- Mounting type: Rear fastened
- Part No.: MB16MSARHD\*\*ST-6

\*\* refers to pins number

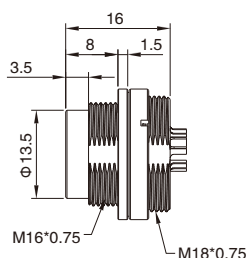
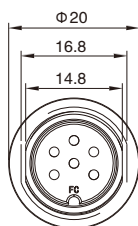

### General information

Standard:	IEC 61076-2-106
Ambient temperature:	-25°C ~ +70°C
Connector insert:	BPT
Connector contacts:	Brass with gold plated
Connector screw/body:	Zinc alloy with nickel plated
Coupling screw:	Brass with nickel plated

Seal/ O-ring:	NBR/FKM
Insulation resistance:	≥ 100MΩ
Contact resistance :	≤ 5mΩ
Shielding:	Unavailable
IP rating:	IP65, IP67 in locked condition
Mating endurance:	>100 cycles

### Electrical data & Mechanical data

Contacts	Contact termination	Rated current	Voltage		Wire gauge / size		Cable jacket	Part No.	
			A/C	D/C	AWG	mm <sup>2</sup>			
02 pins		Solder version	7A(40°C)	250V	32V	18AWG	0.75	PUR/PVC	MB16MSARHD02ST-6
03 pins		Solder version	7A(40°C)	250V	32V	18AWG	0.75	PUR/PVC	MB16MSARHD03ST-6
04 pins		Solder version	6A(40°C)	250V	32V	18AWG	0.75	PUR/PVC	MB16MSARHD04ST-6
05 pins-a		Solder version	6A(40°C)	250V	32V	18AWG	0.75	PUR/PVC	MB16MSARHD05AST-6
05 pins-b		Solder version	6A(40°C)	60V	32V	18AWG	0.75	PUR/PVC	MB16MSARHD05BST-6
06 pins		Solder version	5A(40°C)	250V	32V	18AWG	0.75	PUR/PVC	MB16MSARHD06ST-6
07 pins-a		Solder version	5A(40°C)	125V	32V	18AWG	0.75	PUR/PVC	MB16MSARHD07AST-6
07 pins-b		Solder version	5A(40°C)	60V	32V	18AWG	0.75	PUR/PVC	MB16MSARHD07BST-6
08 pins		Solder version	5A(40°C)	60V	32V	18AWG	0.75	PUR/PVC	MB16MSARHD08ST-6
14 pins		Solder version	3A(40°C)	60V	32V	Max.24AWG	Max.0.25	PUR/PVC	MB16MSARHD14ST-6
19 pins		Solder version	3A(40°C)	60V	32V	Max.24AWG	Max.0.25	PUR/PVC	MB16MSARHD19ST-6

### Remarks

- Please refer to Page 578 for the Conversion between American Wire Gauge AWG and Wire Cross-section mm<sup>2</sup>.
- Please Refer to page 292 for products' part number encoding rule.

## M16 Female Panel Mount, Die-cast Screw, Solder, Rear fastened

- Connector series: M16
- Gender: Female
- Locking type: Fix screw
- Mounting type: Rear fastened
- Part No.: MB16FSARHD\*\*ST-6

\*\* refers to pins number

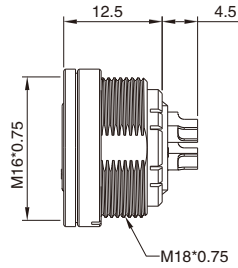
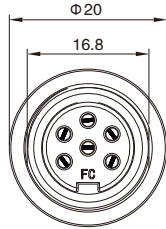

### General information

Standard:	IEC 61076-2-106
Ambient temperature:	-25°C ~ +70°C
Connector insert:	BPT
Connector contacts:	Brass with gold plated
Connector screw/body:	Zinc alloy with nickel plated
Coupling screw:	Brass with nickel plated

Seal/ O-ring:	NBR/FKM
Insulation resistance:	≥ 100MΩ
Contact resistance :	≤ 5mΩ
Shielding:	Unavailable
IP rating:	IP65, IP67 in locked condition
Mating endurance:	>100 cycles

### Electrical data & Mechanical data

Contacts	Contact termination	Rated current	Voltage		Wire gauge / size		Cable jacket	Part No.
			A/C	D/C	AWG	mm <sup>2</sup>		
02 pins	Solder version	7A(40°C)	250V	32V	18AWG	0.75	PUR/PVC	MB16FSARHD02ST-6
03 pins	Solder version	7A(40°C)	250V	32V	18AWG	0.75	PUR/PVC	MB16FSARHD03ST-6
04 pins	Solder version	6A(40°C)	250V	32V	18AWG	0.75	PUR/PVC	MB16FSARHD04ST-6
05 pins-a	Solder version	6A(40°C)	250V	32V	18AWG	0.75	PUR/PVC	MB16FSARHD05AST-6
05 pins-b	Solder version	6A(40°C)	60V	32V	18AWG	0.75	PUR/PVC	MB16FSARHD05BST-6
06 pins	Solder version	5A(40°C)	250V	32V	18AWG	0.75	PUR/PVC	MB16FSARHD06ST-6
07 pins-a	Solder version	5A(40°C)	125V	32V	18AWG	0.75	PUR/PVC	MB16FSARHD07AST-6
07 pins-b	Solder version	5A(40°C)	60V	32V	18AWG	0.75	PUR/PVC	MB16FSARHD07BST-6
08 pins	Solder version	5A(40°C)	60V	32V	18AWG	0.75	PUR/PVC	MB16FSARHD08ST-6
14 pins	Solder version	3A(40°C)	60V	32V	Max.24AWG	Max.0.25	PUR/PVC	B16FSARHD14ST-6
19 pins	Solder version	3A(40°C)	60V	32V	Max.24AWG	Max.0.25	PUR/PVC	B16FSARHD19ST-6

### Remarks

- Please refer to Page 578 for the Conversion between American Wire Gauge AWG and Wire Cross-section mm<sup>2</sup>.
- Please Refer to page 292 for products' part number encoding rule.

## M16 Male Molded Cable, Straight, Quick-lock Type

- Connector series: M16
- Gender: Male
- Locking type: Quick-lock
- Mounting type: Straight
- Part No.: MA16MAQ\*\*STXXX34

\*\* refers to pins number  
X refers to cable specification

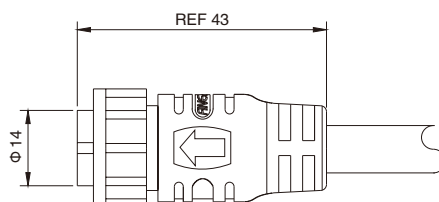

### General information

Ambient temperature:	-40°C ~ +80°C(fixed installation) -20°C ~ +80°C(flexible installation)
Connector insert:	PA + GF
Connector contacts:	Brass with gold plated
Connector overmold:	TPU
Quick-lock fix cap:	PA+GF
Seal / O-ring:	FKM

Insulation resistance:	≥ 100MΩ
Contact resistance :	≤ 5mΩ
Shielding:	Unavailable
IP rating:	IP65, IP67 in locked condition
Mating endurance:	>100 cycles

### Electrical data & Mechanical data

Contacts	Rated current	Voltage		Wire gauge / size		Cable jacket	Wire insulation	Part No.
		A/C	D/C	AWG	mm <sup>2</sup>			
08 pins	4A	250V	300V	22AWG	0.34	PUR/PVC	PVC	MA16MAQ08STXXXB34
09 pins	4A	250V	300V	22AWG	0.34	PUR/PVC	PVC	MA16MAQ09STXXXB34

Note: X refers to cable specification

### Remarks

- Please refer to Page 578 for the Conversion between American Wire Gauge AWG and Wire Cross-section mm<sup>2</sup>.
- Please Refer to page 292 for products' part number encoding rule.

## M16 Female Molded Cable, Straight, Quick-lock Type

- Connector series: M16
- Gender: Female
- Locking type: Quick-lock
- Mounting type: Straight
- Part No.: MA16FAQ\*\*STXXX34

\*\* refers to pins number  
X refers to cable specification

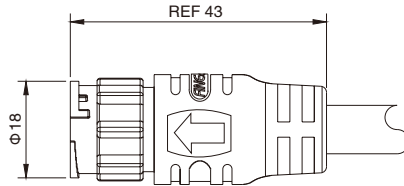

### General information



Ambient temperature:	-40°C ~ +80°C(fixed installation) -20°C ~ +80°C(flexible installation)
Connector insert:	PA + GF
Connector contacts:	Brass with gold plated
Connector overmold:	TPU

Insulation resistance:	≥ 100MΩ
Contact resistance :	≤ 5mΩ
Shielding:	Unavailable
IP rating:	IP65, IP67 in locked condition
Mating endurance:	>100 cycles

### Electrical data & Mechanical data

Contacts	Rated current	Voltage		Wire gauge / size		Cable jacket	Wire insulation	Part No.
		A/C	D/C	AWG	mm <sup>2</sup>			
08 pins 	4A	250V	300V	22AWG	0.34	PUR/PVC	PVC	MA16FAQ08STXXXB34
09 pins 	4A	250V	300V	22AWG	0.34	PUR/PVC	PVC	MA16FAQ09STXXXB34

Note: X refers to cable specification

### Remarks

- Please refer to Page 578 for the Conversion between American Wire Gauge AWG and Wire Cross-section mm<sup>2</sup>.
- Please Refer to page 292 for products' part number encoding rule.

## M16 Female Molded Cable, Straight, Quick-lock Type, With Fix-cap

- Connector series: M16
- Gender: Female
- Locking type: Quick-lock
- Mounting type: Straight
- Part No.: MA16FRQ\*\*STXXX34  
(Reversed polarity)
- \*\* refers to pins number
- X refers to cable specification

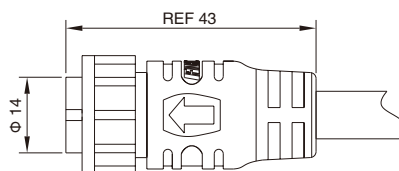

### General information



Ambient temperature:	-40°C ~ +80°C(fixed installation) -20°C ~ +80°C(flexible installation)
Connector insert:	PA + GF
Connector contacts:	Brass with gold plated
Connector overmold:	TPU
Quick-lock fix cap:	PA+GF
Seal / O-ring:	FKM

Insulation resistance:	≥ 100MΩ
Contact resistance :	≤ 5mΩ
Shielding:	Unavailable
IP rating:	IP65, IP67 in locked condition
Mating endurance:	>100 cycles

### Electrical data & Mechanical data

Contacts	Rated current	Voltage		Wire gauge / size		Cable jacket	Wire insulation	Part No.
		A/C	D/C	AWG	mm <sup>2</sup>			
08 pins 	4A	250V	300V	22AWG	0.34	PUR/PVC	PVC	MA16FRQ08STXXXB34
09 pins 	4A	250V	300V	22AWG	0.34	PUR/PVC	PVC	MA16FRQ09STXXXB34

Note: X refers to cable specification

### Remarks

- Please refer to Page 578 for the Conversion between American Wire Gauge AWG and Wire Cross-section mm<sup>2</sup>.
- Please Refer to page 292 for products' part number encoding rule.



## M16 Male Field Wirable Assembly, Straight, Quick-lock Type, Solder

- Connector series: M16
- Gender: Male
- Locking type: Quick-lock
- Mounting type: Plastic mounting
- Part No.: MB16MAAQ\*\*ST

\*\* refers to pins number

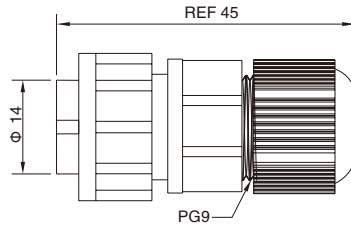

### General information

RoHS

Ambient temperature:	-25°C ~ +90°C
Connector insert/body:	PA + GF
Connector contacts:	Brass with gold plated
Quick-lock fix cap:	PA+GF
O-ring:	FKM

Insulation resistance:	≥ 100MΩ
Contact resistance :	≤ 5mΩ
Shielding:	Unavailable
Suitable cable Dia:	5.0~8.5mm
IP rating:	IP65, IP67 in locked condition
Mating endurance:	>100 cycles

### Electrical data & Mechanical data

Contacts	Contact termination	Rated current	Voltage		Wire gauge / size		Cable jacket	Wire insulation	Part No.
			A/C	D/C	AWG	mm <sup>2</sup>			
08 pins	Solder version	4A	250V	300V	22AWG	0.34	PUR/PVC	PVC	MB16MAAQ08ST
09 pins	Solder version	4A	250V	300V	22AWG	0.34	PUR/PVC	PVC	MB16MAAQ09ST

### Remarks

- Please refer to Page 578 for the Conversion between American Wire Gauge AWG and Wire Cross-section mm<sup>2</sup>.
- Please Refer to page 292 for products' part number encoding rule.

## M16 Female Field Wirable Assembly, Straight, Quick-lock Type, Solder

- Connector series: M16
- Gender: Female
- Locking type: Quick-lock
- Mounting type: Plastic mounting
- Part No.: MB16FAAQ\*\*ST

\*\* refers to pins number

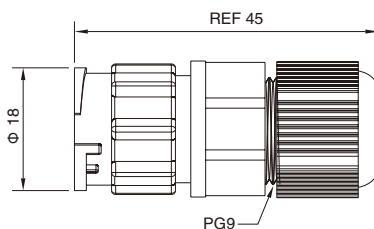

### General information



Ambient temperature:	-25°C ~ +90°C
Connector insert/body:	PA + GF
Connector contacts:	Brass with gold plated
O-ring:	FKM

Insulation resistance:	≥ 100MΩ
Contact resistance :	≤ 5mΩ
Shielding:	Unavailable
Suitable cable Dia:	5.0~8.5mm
IP rating:	IP65, IP67 in locked condition
Mating endurance:	>100 cycles

### Electrical data & Mechanical data

Contacts	Contact termination	Rated current	Voltage		Wire gauge / size		Cable jacket	Wire insulation	Part No.
			A/C	D/C	AWG	mm <sup>2</sup>			
08 pins 	Solder version	4A	250V	300V	22AWG	0.34	PUR/PVC	PVC	MB16FAAQ08ST
09 pins 	Solder version	4A	250V	300V	22AWG	0.34	PUR/PVC	PVC	MB16FAAQ09ST

### Remarks

- Please refer to Page 578 for the Conversion between American Wire Gauge AWG and Wire Cross-section mm<sup>2</sup>.
- Please Refer to page 292 for products' part number encoding rule.

## M16 Female Field Assembly, Straight, Quick-lock Type, Solder, With Fix-cap

- Connector series: M16
- Gender: Female
- Locking type: Quick-lock
- Mounting type: Plastic mounting
- Part No.: MB16FRAMQ\*\*ST  
(Reversed polarity)
- \*\* refers to pins number

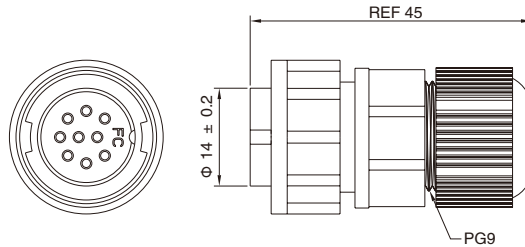

### General information



Ambient temperature:	-25°C ~ +90°C
Connector insert/body:	PA + GF
Connector contacts:	Brass with gold plated
Quick-lock fix cap:	PA+GF
O-ring:	FKM

Insulation resistance:	≥ 100MΩ
Contact resistance :	≤ 5mΩ
Shielding:	Unavailable
Suitable cable Dia:	5.0~8.5mm
IP rating:	IP65, IP67 in locked condition
Mating endurance:	>100 cycles

### Electrical data & Mechanical data

Contacts	Contact termination	Rated current	Voltage		Wire gauge / size		Cable jacket	Wire insulation	Part No.	
			A/C	D/C	AWG	mm <sup>2</sup>				
08 pins		Solder version	4A	250V	300V	22AWG	0.34	PUR/PVC	PVC	MB16FRAMQ08ST
09 pins		Solder version	4A	250V	300V	22AWG	0.34	PUR/PVC	PVC	MB16FRAMQ09ST

### Remarks

- Please refer to Page 578 for the Conversion between American Wire Gauge AWG and Wire Cross-section mm<sup>2</sup>.
- Please Refer to page 292 for products' part number encoding rule.

## M16 Male Panel Mount, Straight, Quick-lock Type, Solder, Front fastened

- Connector series: M16
- Gender: Male
- Locking type: Quick-lock
- Mounting type: Front fastened
- Part No.: MB16MSAFQ\*\*ST

\*\* refers to pins number

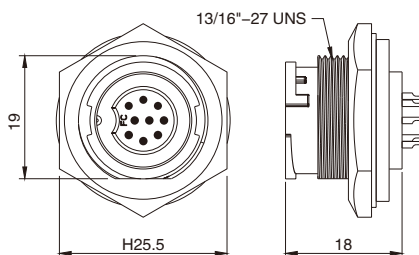

### General information



Ambient temperature:	-25°C ~ +90°C
Connector insert:	PA + GF
Connector contacts:	Brass with gold plated
Coupling nut/screw:	PA+GF
Seal / O-ring:	Epoxy resin / FKM

Insulation resistance:	≥ 100MΩ
Contact resistance :	≤ 5mΩ
Shielding:	Unavailable
IP rating:	IP65, IP67 in locked condition
Mating endurance:	>100 cycles

### Electrical data & Mechanical data

Contacts	Contact termination	Rated current	Voltage		Wire gauge / size		Wire insulation	Part No.	
			A/C	D/C	AWG	mm <sup>2</sup>			
08 pins		Solder version	4A	250V	300V	22AWG	0.34	PVC wire or customized	MB16MSAFQ08ST
09 pins		Solder version	4A	250V	300V	22AWG	0.34	PVC wire or customized	MB16MSAFQ09ST

### Panel Cut-out Dimensions

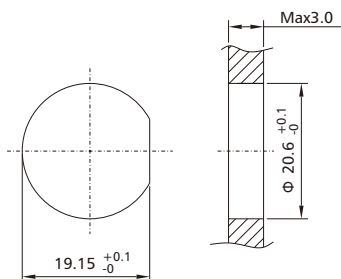

### Remarks

- Please refer to Page 578 for the Conversion between American Wire Gauge AWG and Wire Cross-section mm<sup>2</sup>.
- Please Refer to page 292 for products' part number encoding rule.

## M16 Female Panel Mount, Quick-lock Type, Solder, Front fastened

- Connector series: M16
- Gender: Female
- Locking type: Quick-lock
- Mounting type: Front fastened
- Part No.: MB16FSAFQ\*\*ST

\*\* refers to pins number

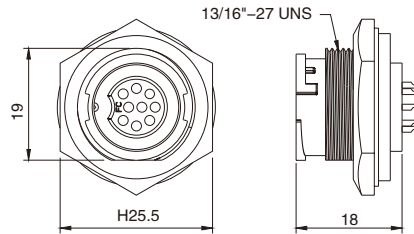

### General information



Ambient temperature:	-25°C ~ +90°C
Connector insert:	PA + GF
Connector contacts:	Brass with gold plated
Coupling nut/screw:	PA+GF
Seal / O-ring:	Epoxy resin / FKM

Insulation resistance:	≥ 100MΩ
Contact resistance :	≤ 5mΩ
Shielding:	Unavailable
IP rating:	IP65, IP67 in locked condition
Mating endurance:	>100 cycles

### Electrical data & Mechanical data

Contacts	Contact termination	Rated current	Voltage		Wire gauge / size		Wire insulation	Part No.	
			A/C	D/C	AWG	mm <sup>2</sup>			
08 pins		Solder version	4A	250V	300V	22AWG	0.34	PVC wire or customized	MB16FSAFQ08ST
09 pins		Solder version	4A	250V	300V	22AWG	0.34	PVC wire or customized	MB16FSAFQ09ST

### Panel Cut-out Dimensions

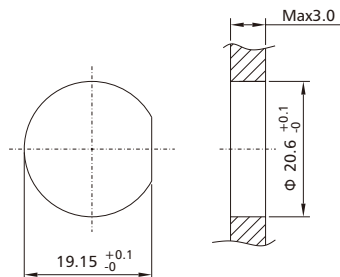

### Remarks

- Please refer to Page 578 for the Conversion between American Wire Gauge AWG and Wire Cross-section mm<sup>2</sup>.
- Please Refer to page 292 for products' part number encoding rule.

## M16 Male Panel Mount, Quick-lock Type, PCB Type, Front fastened

- Connector series: M16
- Gender: Male
- Locking type: Quick-lock
- Mounting type: Front fastened
- Part No.: MB16MBAFQ\*\*ST

\*\* refers to pins number

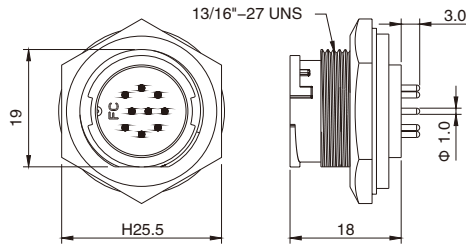

### General information



Ambient temperature:	-25°C ~ +90°C
Connector insert:	PA + GF
Connector contacts:	Brass with gold plated
Coupling nut/screw:	PA+GF
Seal / O-ring:	Epoxy resin / FKM

Insulation resistance:	≥ 100MΩ
Contact resistance :	≤ 5mΩ
Shielding:	Unavailable
IP rating:	IP65, IP67 in locked condition
Mating endurance:	>100 cycles

### Electrical data & Mechanical data

Contacts	Contact termination	Rated current	Voltage		Part No.
			A/C	D/C	
08 pins	PCB version	4A	250V	300V	MB16MBAFQ08ST
09 pins	PCB version	4A	250V	300V	MB16MBAFQ09ST

### Panel Cut-out Dimensions

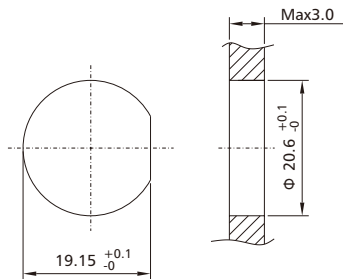

### PCB Layout

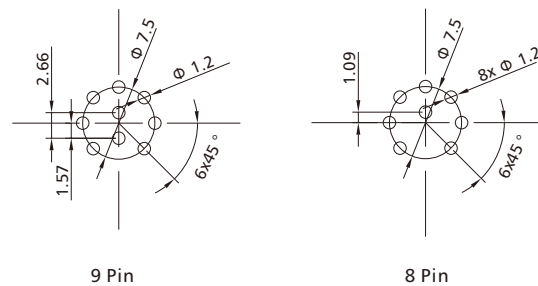

### Remarks

- Please Refer to page 292 for products' part number encoding rule.

## M16 Female Panel Mount, Quick-lock Type, PCB Type, Front fastened

- Connector series: M16
- Gender: Female
- Locking type: Quick-lock
- Mounting type: Front fastened
- Part No.: MB16FBAFQ\*\*ST

\*\* refers to pins number

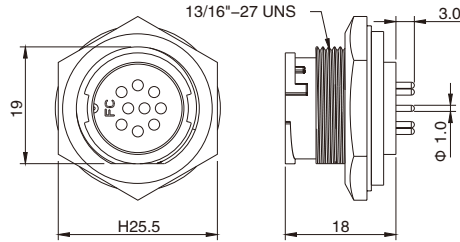

### General information



Ambient temperature:	-25°C ~ +90°C
Connector insert:	PA + GF
Connector contacts:	Brass with gold plated
Coupling nut/screw:	PA+GF
Seal / O-ring:	Epoxy resin / FKM

Insulation resistance:	≥ 100MΩ
Contact resistance :	≤ 5mΩ
Shielding:	Unavailable
IP rating:	IP65, IP67 in locked condition
Mating endurance:	>100 cycles

### Electrical data & Mechanical data

Contacts	Contact termination	Rated current	Voltage		Part No.
			A/C	D/C	
08 pins	PCB version	4A	250V	300V	MB16FBAFQ08ST
09 pins	PCB version	4A	250V	300V	MB16FBAFQ09ST

### Panel Cut-out Dimensions

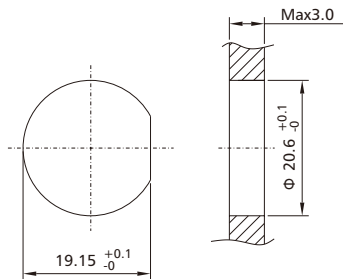

### PCB Layout

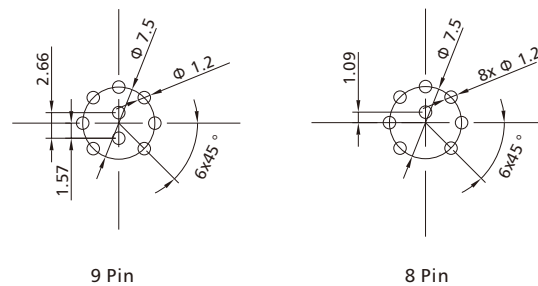

### Remarks

- Please Refer to page 292 for products' part number encoding rule.

## M16 Protection Cap for Male With Fix-Cap Cable Connector

- Connector series: M16
- Gender: for Male
- Locking type: Quick-lock
- Part No.: PCSM16-1

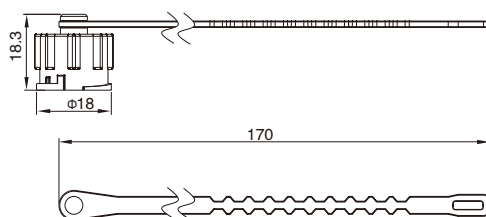

### General information

Material:	PA+GF
Loop:	TPU
Color:	Black
Degree of protection:	IP65, IP67 in locked condition

## M16 Protection Cap for female Molded cable connector without fix cap

- Connector series: M16
- Gender: for Female
- Locking type: Quick-lock
- Part No.: PCNM16-1

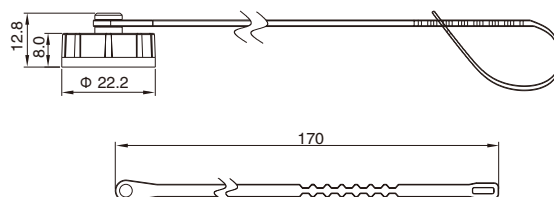

### General information

Material:	PA+GF
Gasket:	FKM
Loop:	TPU
Color:	Black
Degree of protection:	IP65, IP67 in locked condition



## M16 Protection Cap for Male/ Female Panel-mount Connector

- Connector series: M16
- Gender: for Male/Female
- Locking type: Quick-lock
- Part No.: PCNM16-2

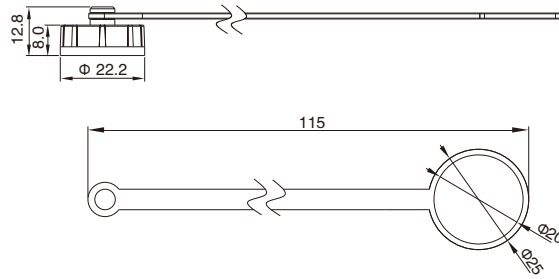

### General information

Material:	PA+GF
Gasket:	FKM
Loop:	TPU
Color:	Black
Degree of protection:	IP65, IP67 in locked condition

## M16 Connector Accessories

### Type

### Part number

### Accessories

Assembly tool for M16 connectors  
For connectors with female thread

M16-TOOL-1

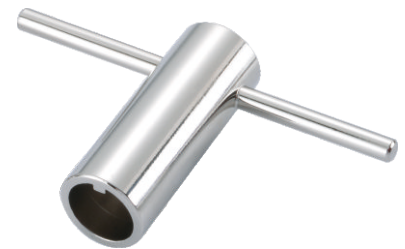

### Type

### Part number

### Accessories

Assembly tool for M16 connectors  
For connectors with male thread

M16-TOOL-2

